

Ordinance 92-9

Zoning Map

Dec 28, '92

ORDINANCE NO. 92-9, 1992

AN ORDINANCE OF THE TOWNSHIP OF HOPEWELL
AMENDING THE OFFICIAL ZONING MAP OF THE
HOPEWELL TOWNSHIP ZONING ORDINANCE NO. 85-5,
1985

WHEREAS, the Board of Commissioners of the Township of Hopewell did receive an application for an amendment to the Hopewell Township Zoning Ordinance from Maronda Homes, Inc., in connection with a parcel of land consisting of approximately 80.79 acres and off of Airport Road in the Township of Hopewell and bearing tax parcel number 65-40-0222. Said application requesting that the parcel be rezoned from R-1, Restricted Residential to R-4 Residential High District. The exact location of said parcel is indicated in Exhibit "A" which is attached hereto and made a part of the within Ordinance; and

WHEREAS, the Hopewell Township Planning Commission at their regularly scheduled monthly meeting held August 4, 1992, unanimously recommended approval of said amendment; and

WHEREAS, a public hearing was held by the Hopewell Township Board of Commissioners on August 24, 1992, at 8:00 P.M., pursuant to public notice, in connection with the proposed Zoning Map Amendment; and

WHEREAS, after due and careful consideration of the recommendations made by both the Hopewell Township Planning Commission and the Beaver County Planning Commission, and a review of the stenographic record made of the public hearing on August 24, 1992, the Board of Commissioners of the Township of Hopewell hereby enact the following amendment:

BE IT ENACTED AND THE SAME IS HEREBY ENACTED THAT:

1. The Official Zoning Map of the Township of Hopewell Zoning Ordinance is hereby amended to change R-1 Restricted Residential to R-4 Residential High District with reference to those parcels or parts of parcels of land lying along Airport Road and containing approximately 80.79 acres (Eighty Point Seventy Nine); an identification of the affected parcels, by tax parcel numbers is marked Exhibit "A" and attached hereto and made a part hereof. The area of the Official Zoning Map being amended as aforesaid is marked Exhibit "B" and is attached hereto and made a part hereof.

Adopted this 28 day of DECEMBER, 1992, pursuant to the authority contained in the Hopewell Township Zoning Ordinance, the First Class Township Code, and the Municipalities Planning Code.

TOWNSHIP OF HOPEWELL



Tim Force, President of Hopewell Township
Board of Commissioners

Date

Secretary - Manager

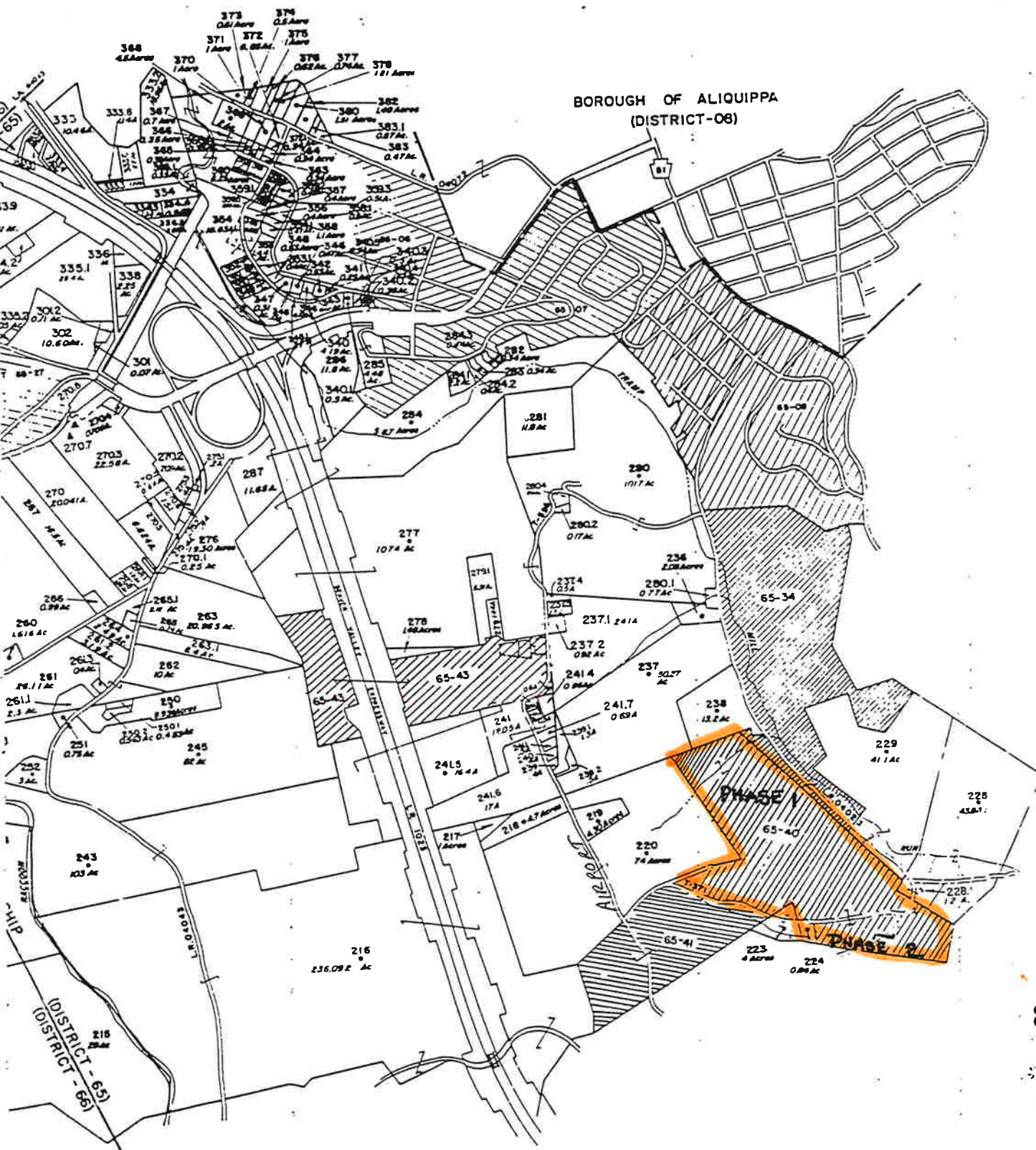

821

<p>KEY MAP</p>	<p>PREPARED BY MICHAEL BAKER, JR., INC. CONSULTING ENGINEERS ROCHESTER, PENNSYLVANIA</p>	<p>SCALE IN FEET</p>	<p>BEAVER COUNTY Pennsylvania 1937</p>	<p>75 RACCOON TWP 66 INDEPENDENCE TOWNSHIP 65 HOPEWELL TWP</p>	<p>DISTRICT NO. 1 75,66,65 1937</p>
----------------	--	----------------------	--	--	---

EXHIBIT "A"